



MAR 2,2006

QUOTATION

Page 1 of 4
SANQUIN

Project:
San Quintin School

San Quintin,

From:
George Orness
Orness Design Group
5955 Mira Mesa Blvd. Ste. H
San Diego, CA 92121
(858) 457-5955 Fax: (858) 457-5950

To:
Dan Henderson
Del Mar Rotary Club

Del Mar, CA 92014
(858) 794-8620

We are pleased to quote the following

Item	Qty	Description	Sell Each	Sell Total
1	4 ea	SHELVING, WIRE IRSG Model No. 1836Z Standard Wire Shelf, 18"W x 36"L, (4) plastic split sleeves, zinc plated, NSF for dry & heated environments	18.58	74.32
	4 ea	P74Z Stationary Post, 74-3/8"H, numbered on 1" increments, double grooved every 5", zinc plated, NSF for dry & heated environments	6.91	27.64
		Extended Total for Item No. 1		101.96
2	1 ea	SINK 1-COMPARTMENT Turbo Air Model No. TSA-1-N Prep Sink, One Compartment, 18" wide x 18" front-to-back, 13" deep w/11" high splash, 18/304 stainless steel bowl, galvanized gussets & tubular legs w/adjustable ABS feet, NSF approved	210.20	210.20
2.1	1 ea	FAUCET, WORKBOARD Fisher Model No. 83968 Workboard Faucet, 8" C.C. backsplash mount, 14" swing spout, elbows	104.28	104.28
3	1 ea	SHELF, WALL-MOUNTED Turbo Air Model No. TSWs-1236 Wall Mount Shelf, 12 x 36, stainless steel	50.65	50.65
4	1 ea	SINK 3-COMPARTMENT Turbo Air Model No. TSA-3-14-D1 Sink, Three Compartment, with 18" left & right-hand drainboards, 18" front-to-back x 18" wide sink compartments, 14" deep with 11" high splash, 18/304 stainless steel bowls, galvanized gussets & tubular legs w/adjustable ABS feet, NSF approved	501.46	501.46

Item	Qty	Description	Sell Each	Sell Total
5	1 ea	PRE-RINSE UNIT Fisher Model No. 89508 Pre-Rinse Assembly, backsplash mounted, 8" C.C., Ultra Spray Valve, 36" flexible stainless steel hose, wall bracket, backflow preventer, add-on faucet w/12" swing spout, elbows	326.29	326.29
6	1 ea	SHELF, WALL-MOUNTED Turbo Air Model No. TSWs-1236 Wall Mount Shelf, 12 x 36, stainless steel	50.65	50.65
7		Spare Number		
8		Spare Number		
9		Spare Number		
10		work table existing.		
11	1 ea	REFRIG... REACH-IN Victory Refrigeration Model No. VR-2 Refrigerator, Reach-in, two-section, self-contained refrigeration, aluminum exterior & interior, s/s front & doors, std depth cabinet, full-height doors, exterior dial-type thermometer, 5" casters, 1/3 HP	2,750.58	2,750.58
	1	115v/60/1-ph w/cord & plug, std.		
	1	Extended 4-yr. compressor warranty within the USA, valued at \$75.00 net included in equip. price		
	1	V2E Full 2-year parts/labor service warranty within the USA valued at \$105.00 net included in equip. price, std.		
	1	Left door hinged on left, right door hinged on right, standard		
	1	5" casters, std.		
		Extended Total for Item No. 11	2,750.58	
12	1 ea	FREEZER REACH-IN Victory Refrigeration Model No. VF-2 Freezer, Reach-in, two-section, self-contained refrigeration, aluminum exterior & interior, s/s front & doors, std depth cabinet, full-height doors, exterior dial-type thermometer, 5" casters, 1/2 hp	3,588.96	3,588.96
	1	115v/60/1-ph w/cord & plug, std.		
	1	Extended 4-yr. compressor warranty within the USA, valued at \$75.00 net included in equip. price		
	1	V2E Full 2-year parts/labor service warranty within the USA valued at \$105.00 net included in equip. price, std.		
	1	Left door hinged on left, right door hinged on right, standard		
	1	5" casters, std.		
		Extended Total for Item No. 12	3,588.96	
13		Spare Number		
14		Spare Number		
15	1 ea	GRIDDLE, COUNTER UNIT, GAS Imperial Model No. ITG-36 Elite Griddle, Counter Unit, Gas, 1" thick highly polished steel griddle plate, 36"W x 24"D grill area, 3" wide front grease trough, thermostatic controls, s/s front and sides, 4" adj. legs, 90,000 BTU	2,037.30	2,037.30
	1	LP gas		

Item	Qty	Description	Sell Each	Sell Total
	1 ea	ITGS-36 Equipment Stand, for ITG-36 Griddle or ITG-36-OB-2 Griddle/Hotplate, open base, 36" wide, 24" high, stainless steel construction	409.63	409.63
		Extended Total for Item No. 15		2,446.93
16	1 ea	RANGE, GAS, STOCK POT Imperial Model No. ISPA-18 Stock Pot Range, Gas, (1) three ring burner w/ cast-iron top, manual controls, open front cabinet base, cast-iron top grate, stainless steel front and sides, 6" adj. legs w/adj. feet, 90,000 BTU	751.01	751.01
17	1 ea	RANGE, GAS, STOCK POT Imperial Model No. ISPA-18 Stock Pot Range, Gas, (1) three ring burner w/ cast-iron top, manual controls, open front cabinet base, cast-iron top grate, stainless steel front and sides, 6" adj. legs w/adj. feet, 90,000 BTU	751.01	751.01
	1	LP gas		
		Extended Total for Item No. 17		751.01
18		Equipment stand, included with item #15.		
19		Spare Number		
20		Spare Number		
21		Spare Number		
22		Spare Number		
23	1	S/S WALL PANELS Custom Model No. SQ-23 S/S wall panels for below hood.	720.00	720.00
24	1	EXHAUST HOOD Captive-Aire Model No. EXH-8 Custom s/s exhaust hood approximately 48"x84" complete with lights, filters. U.L. listed.	2,160.00	2,160.00
25	1	EXHAUST FAN Captive-Aire Model No. SQ-25 Exhaust fan sized to accommodate exhaust hood. curb included.	900.00	900.00
26		Make-up air. NIC		
27		Fire suppression system, NIC		
28		Spare Number		
29		Spare Number		
30	1 ea	WORK TABLE, 48" LONG Turbo Air Model No. TSW-3048E Work Table, 30" W x 48" L, 18/430 stainless steel flat top w/turned down edges, w/adjustable galvanized undershelf & legs w/adjustable ABS bullet feet, NSF approved	150.37	150.37
31	1 ea	BUFFET, HOT FOOD, ELECTRIC Vollrath Company L.L.C. Model No. 38118 ServeWell Buffet, Hot Food, Electric Table, 4 well, stainless 300 series, ind controlled thermoset no-drip wells, elements mounted inside well, drains std, plate shelf, cut board, peg legs, 240V,3200W,13.3A,6-20 plug, 60-3/4"Lx32"Wx34"H, KD, cUL,NSF,USA	1,268.40	1,268.40

Item	Qty	Description	Sell Each	Sell Total
32		Steam table, included with item #31.		
33	1 ea	MILK COOLER Beverage Air Model No. SM34N-W School Milk Cooler, normal temp, 34" long, single access, white exterior, galvanized interior, with s/s door, flat top carton capacities, (793) 1/3 qt., (1001) 1/2 pt., case capacities, (8) 13" x 13" x 11"	1,696.50	1,696.50
	1	NOTE: Transitioning from Spartanburg Distribution Center to Brookville Distribution Center in 2006. Contact factory for warehouse location.		
	1	Limited Warranty: One (1) year parts and labor		
	1	Addition 4 yr compressor warranty std.		
	1	Export voltages (consult factory)		
	1	4" Swivel casters (2) with brakes, std.		
Extended Total for Item No. 33				1,696.50
			Total	18,529.25
			Sales Tax (@ 7.750%)	1,436.02
			Grand Total	19,965.27

Thank you for this opportunity

Acceptance: _____

Date: _____

VIIDAI Budget

Price	Total needed	#/ sem	Total	Description	Qty	Cat #	Vendor
\$220.00	4	2	\$880.00	Hemoglobin cuvettes for anemia testing ^a	200/bx	651200	HemoCue Inc.
\$40.00	4	2	\$160.00	Lancets to prick fingers for anemia testing ^a	200/bx	130148	HemoCue Inc.
\$800.00	1	0.5	\$800.00	Photometer (Hemocue reader) ^a	each	651100	HemoCue Inc.
\$200.00	1	0.5	\$200.00	Maintenance for Photometer(Hemocue) ^a			HemoCue Inc.
\$26.00	2	1	\$52.00	Shipping costs for anemia testing supplies ^a			HemoCue Inc.
\$2.99	30	15	\$89.70	Crayons for nutrition coloring books ^c	64/bx		Target
\$1.50	400	200	\$600.00	Soap for hygiene education ^c	2/bag		99 cent store
\$0.10	400	200	\$40.00	Nutrition coloring book copies ^c	each copy		Staples
\$2.00	400	200	\$800.00	Anemia handout -color copies- 2 sided ^c	each		Staples
\$0.10	400	200	\$40.00	Surveys for needs assessment collection ^b	each copy		Staples
\$0.10	800	400	\$80.00	Consents for needs assessment collection ^b	each copy		Staples
\$5.99	4	2	\$23.96	Balloons to identify anemia houses ^a	50 balloons		Target
\$20.00	2	1	\$40.00	Clear badge holders for identification ^b			Staples
\$7.00	4	2	\$28.00	Sharpie pens ^b			Staples
\$20.00	2	1	\$40.00	AAA batteries for walkie-talkies/translation equipment ^b	48		Costco
\$13.00	2	1	\$26.00	AA batteries for walkie-talkies/translation equipment ^b	36		Costco
\$15.00	2	1	\$30.00	Clipboards ^b			Staples
\$15.00	30	15	\$450.00	Vitamins ^c	1 bottle		Costco
\$2.00	400	200	\$800.00	Baby cereal/ iron fortified ^c	per box		Target
	2		\$462.00	*Exam & treatment tables ^e			Earth Lite
2,562	2	1	\$5,123.94	Microscopes (Fisher Scientific) ^d			Fisher Scientific
				Lead test kits (for ceramic pottery-Home Depot) ^a			
Total for 1 year			\$10,765.60				

* Exact Quote to Follow

a- Supplies and equipment to test for anemia

b- Supply support for logistics of the 3 University Field Teams

c- Educational and supplements intervention for anemia, nutritional and hygiene programs

d- Clinical Laboratory Equipment

e- Clinical Equipment

PLEASE CONTACT ME IF YOU HAVE ANY QUESTIONS AT 412-490-1230.
THANK YOU,
MICHELLE

F I S H E R S C I E N T I F I C
Q U O T A T I O N

OCTOBER 13, 2005

PAGE: 1

NAVAL HEALTH RESEARCH CTR
271 CATLINA BLVD
BUILDING 304
ATTN DIANE SERNA
SAN DIEGO CA 92152

FISHER SCIENTIFIC COMPANY LLC
9999 VETERANS MEMORIAL DR
HOUSTON TX 77038

(800) 766-7000

CUST REF NBR PRICING/DIANE

ACCOUNT NBR: 405745-017
QUOTE NBR: 5286-0939-90
TERMS: NET 30 DAYS
DUE DATE:
SALES REP: MICHELLE JORDAN

REQUESTOR: DIANE SERNA
PHONE: 6195535100
FOB: SHIP POINT
AUTHORIZED BY: MICHELLE JORDAN

*** PRICES ARE FIRM THRU 11/12/05 ***
PLEASE REFER TO THE QUOTE NBR ON ALL CORRESPONDENCE
THANK YOU FOR YOUR INTEREST IN FISHER SCIENTIFIC COMPANY LLC

NBR	QTY	UN	CATALOG NBR	DESCRIPTION	UNIT PRC	EXTD PRC
1	2	EA	12 561B	MICROSCOPE BINOC PLAN OBJ	1,188.85	2,377.70
				MERCHANDISE TOTAL		2,377.70
				EST. SALES TAX		184.27
				TOTAL		2,561.97

QUOTATION TERMS AND CONDITIONS

Fisher Scientific Company and/or its Curtin Matheson Scientific division (collectively the "Distributor") will sell to the customer ("Customer") and Customer will purchase from Distributor the quoted products, subject to the following terms and conditions:

PRICES: All prices are quoted F. O. B. shipping point for the indicated firm period. Customer shall pay all federal, state, municipal or other sales or use tax or any other taxes upon the Products or services provided to Customer by Distributor. Distributor reserves the right to make additional charges for special packaging, shipping and handling required to comply with manufacturers' specification, applicable DOT or other regulations, or to meet Customer requirements.

Distributor expressly disclaims any representation or warranty concerning "most favored customer" pricing which may appear in any Customer's documents in connection with the sale of any Products by Distributor to Customer.

TERMS: Distributor's standard terms of 30 days net are applicable to all domestic and foreign shipments. Invoices against Products shipped outside the United States are payable in United States currency. Distributor reserves the right to collect interest at a rate equal to the higher applicable lawful interest rate on invoiced amounts not paid within thirty (30) days of invoice date, with interest to accrue monthly until full payment is received.

DELIVERY: All shipping dates are approximate. Distributor reserves the right to substitute alternate Products with equivalent specifications for those ordered. Customer shall have the right to return any substituted Products at no charge by following Distributor's return goods policy.

PRODUCT WARRANTY AND INDEMNITY: To the extent possible, Distributor will make available to its Customers the manufacturers' warranties for Products purchased by Customer, without recourse to Distributor. Distributor warrants to Customer that during the manufactures specified warranty period, Distributor or manufacturer will, upon prompt notification and compliance with Distributor's instructions, repair or replace, at Distributor's sole option, any Product which is defective in material or workmanship. No employee, agent or representative of Distributor has the authority to bind Distributor to any oral representation or warranty concerning any Product sold. Any oral representation or warranty made prior to the purchase of any Product and not set forth in writing and signed by a duly authorized officer of Distributor shall not be enforceable by Customer. Distributor makes no warranty and shall have no obligation with respect to expendable or consumable parts and supplies nor with respect to damage caused by resulting from accident, misuse, neglect, or unauthorized installation, alterations or repairs to the Products.

DISTRIBUTOR EXPRESSLY DISCLAIMS ALL OTHER WARRANTIES, WHETHER EXPRESS, IMPLIED OR STATUTORY, INCLUDING THE WARRANTIES OF MERCHANTABILITY, AND FITNESS FOR A PARTICULAR PURPOSE. Distributor's sole responsibility and the Customer's exclusive remedy for any claim arising out of the purchase of any Product is repair or replacement, as described above. In no event shall Distributor's liability exceed the purchase price paid therefor; nor shall Distributor be liable for any claims, losses or damages of any third party or for lost profits or any special, indirect, incidental, consequential, or exemplary damages, howsoever arising, even if Distributor has been advised of the possibility of such damages.

Except as otherwise expressly set forth herein, Distributor disclaims any obligation to defend or indemnify Customer, its officers, agents, or employees, from any losses, damages, liabilities, costs or expenses which may arise out of Distributor's acts or omissions or the sale or use of the Products provided to Customer by Distributor.

RETURN GOODS POLICY: Products described in Distributor's policy may be returned to Distributor within 30 days for replacement or adjustment. To assure prompt handling, Customer must obtain a return goods authorization number from Distributor and reference this number on return shipping documents. Returns made without the authorization number will be returned to the Customer, freight collect. Distributor reserves the right to reserve any credit issued to Customer: (i) for any Product not returned after authorization and request by Distributor; or (ii) if, upon return, such Product is determined by Distributor not to be defective. Copies of Distributor's policy are available upon request.

FREIGHT CLAIM POLICY: Even with the greatest of care, occasional damages or shortages are unavoidable. Upon receipt of a shipment from Distributor, Customer shall unpack and inspect it for damage and shortage. Customer shall not accept a damaged or short shipment until the delivering carrier's driver has made a "damage" or "shortage" notation on Customer's copy and the carrier's copy of the freight bill. Customer must notify the carrier immediately.

If damages are noted. Customer should immediately request the carrier to make an inspection. Concealed damage must be reported to the carrier within 15 days of delivery. All shipping containers and packing materials must be retained by Customer for the inspection. Salvage must be held for carrier's disposition.

MEDICARE/MEDICAID REPORTING REQUIREMENTS: The prices shown on this quotation are net of discounts provided at the time of purchase. Some Products may be subject to additional discounts agreed upon between the parties. By accepting such Products, customer agrees to comply with such reporting requirements as may be imposed on it under federal Medicare and Medicaid programs and state health care programs. 42 CFR Section 100.1.952 (N).

SOFTWARE: If the Products include computer programs ("Software"), the "sale" of such Software shall not constitute a sale or transfer of proprietary rights in or to the Software but rather shall only constitute the right and license to use the Software in accordance with applicable specifications, instructions and license terms and conditions of the licensor.

PATENTS: If notified promptly in writing of any action or claim against Customer, that Customer's purchase or use of the Product infringes a United States patent. Distributor will defend such action at its expense and will pay the costs and damages awarded in any such actions, provided Distributor shall have sole control of the defense of the action and all negotiations for its settlement or compromise. Distributor shall not have any liability to Customer if the infringement or claim thereof is based on (i) the use or sale of the Product in combination with other products or devices which are not furnished in combination by Distributor or (ii) the furnishing to Customer of any information, service or applications assistance. In no event shall Distributor's total liability to Customer under this provision exceed the amount paid by Customer to Distributor for the Product alleged to infringe. The foregoing states the entire liability of Distributor to Customer with respect to infringement of patents by the Products, any parts thereof or their operation.

FORCE MAJEURE: The performance by Distributor of any covenant or obligation on its part to be performed under any agreement with Customer shall be excused by floods, strikes, or other labor disturbances, riots, fires, accidents, wars, embargoes, delays of carriers, failure of power, or regular sources of supply, acts, injunctions, or restraints of government, or any other cause preventing such performance, beyond Distributor's reasonable control.

LIMITATION OF ACTIONS: Any cause of action for breach of warranty must be brought by the Customer, if at all, within one (1) year from the date the cause of action accrued. Any discrepancy in Distributor's pricing or other charges shall be deemed waived by Customer unless Customer notifies Distributor thereof, in writing, within ninety (90) days from the date of the invoice on which such disputed transaction is reflected.

MISCELLANEOUS: These Terms and Conditions shall control as to any Products provided by Distributor to Customer hereunder. None of the terms and conditions contained herein may be added to, modified, superseded or otherwise altered except by written instrument signed by duly authorized representatives of Distributor and Customer.

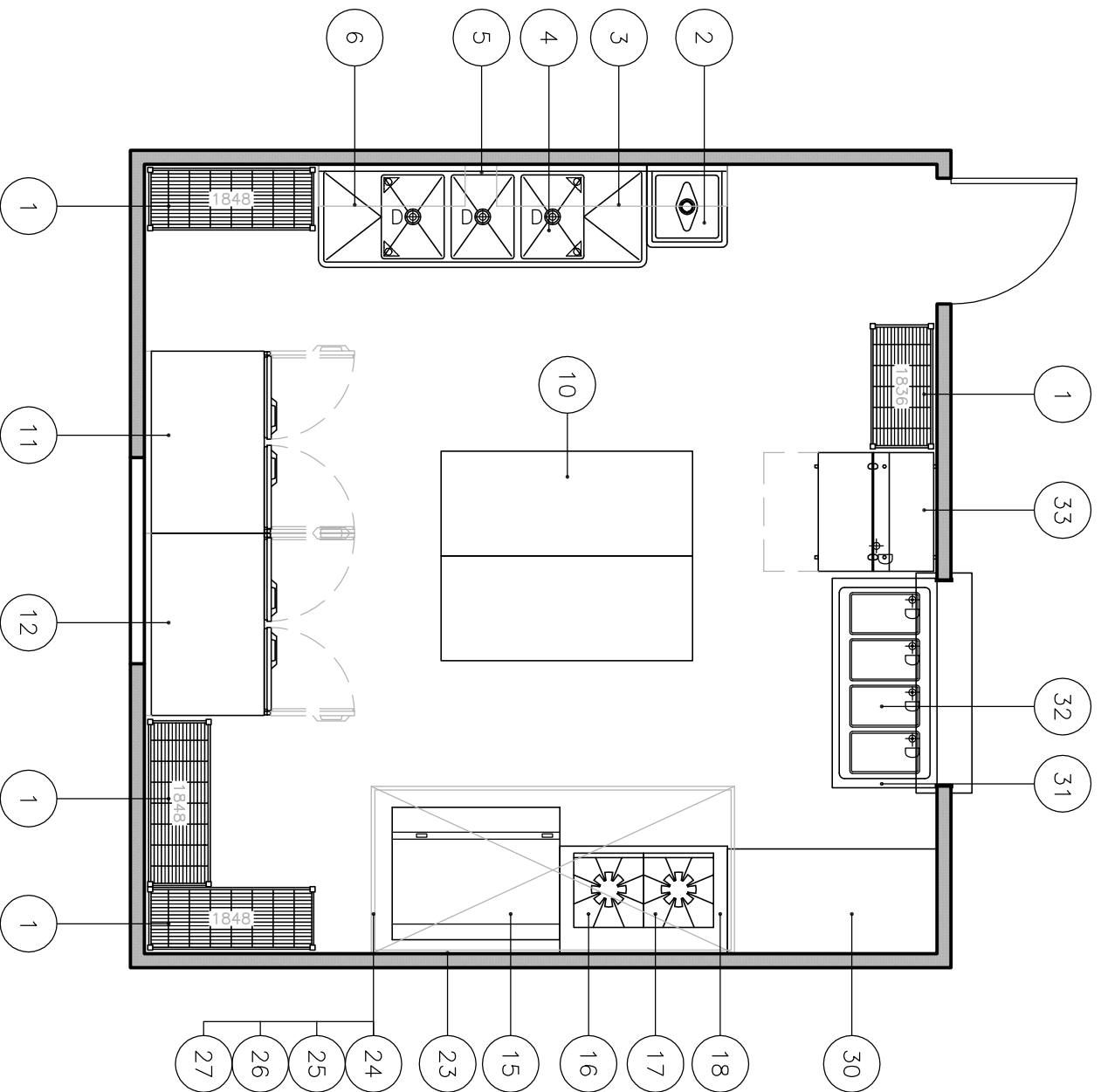

SAN QUINTIN PRELIMINARY FOOD SERVICE PLAN

SCALE: 1/4" = 1'-0"
 DATE: FEB 21, 2006

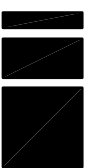

ORNESS | DESIGN GROUP | INC

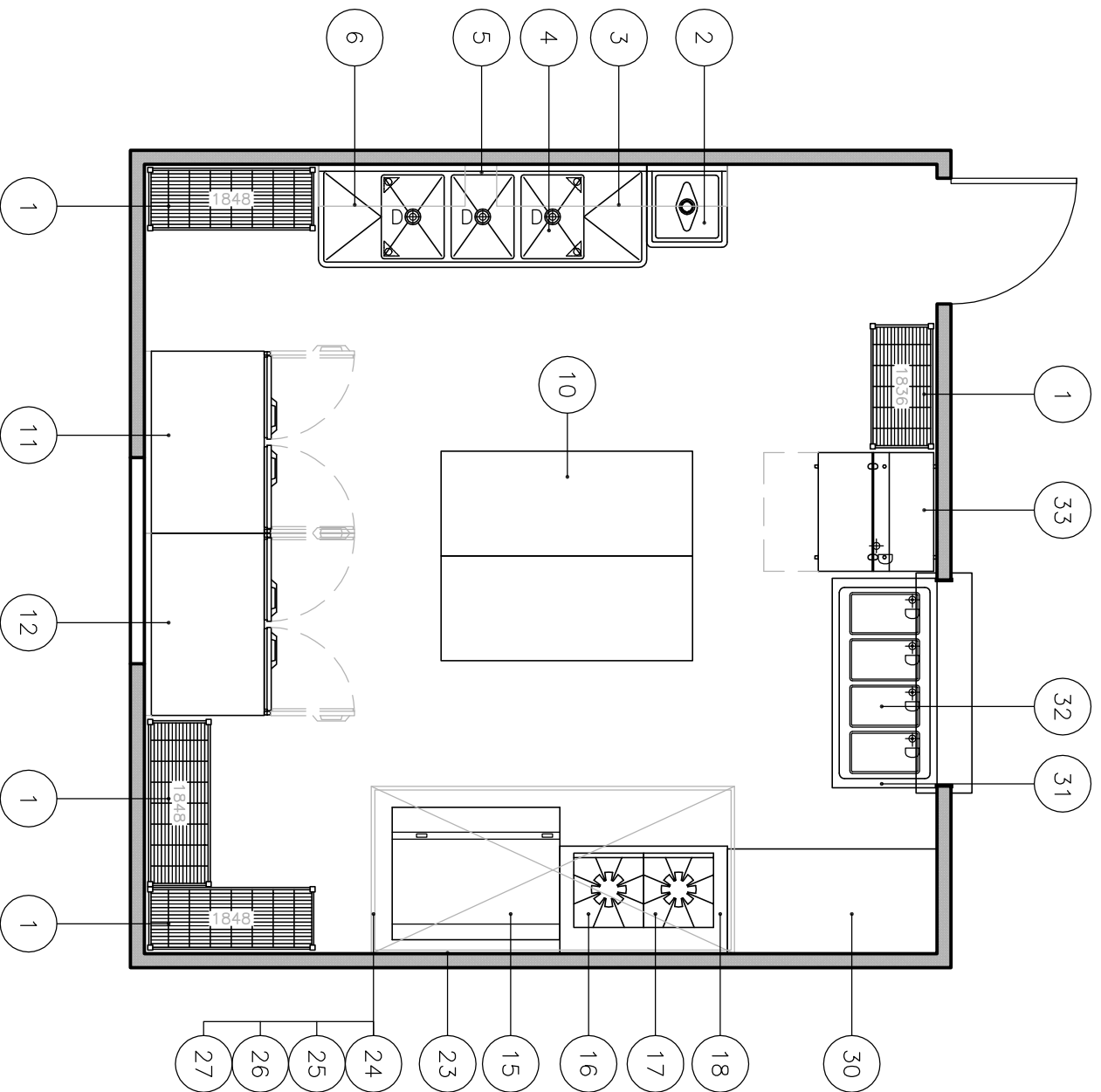

SAN QUINTIN PRELIMINARY FOOD SERVICE PLAN

SCALE: 1/4" = 1'-0"
 DATE: FEB 21, 2006

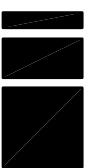

ORNESS | DESIGN GROUP | INC